



各位親愛的讀者您好：

如您在 IE 瀏覽器下使用本館整合查詢系統登入帳號與密碼時

出現以下畫面與文字

Licensing agreements for these databases require that access be extended only to authorized users. Once you have been validated by this system, a "cookie" is sent to your browser as an ongoing indication of your authorization to access these databases. This cookie only needs to be set once during login.

If you are using a firewall or network privacy program, you may need reconfigure it to allow cookies to be set from this server.

As you access databases, they may also use cookies. Your ability to use those databases may depend on whether or not you allow those cookies to be set.

To login again, click [here](#).

here.' The sidebar on the right is identical to the previous screenshot."/>



可以循以下方法設定您的 IE 瀏覽器並獲得解決：

1. 點選 IE 瀏覽器的工具→網際網路選項

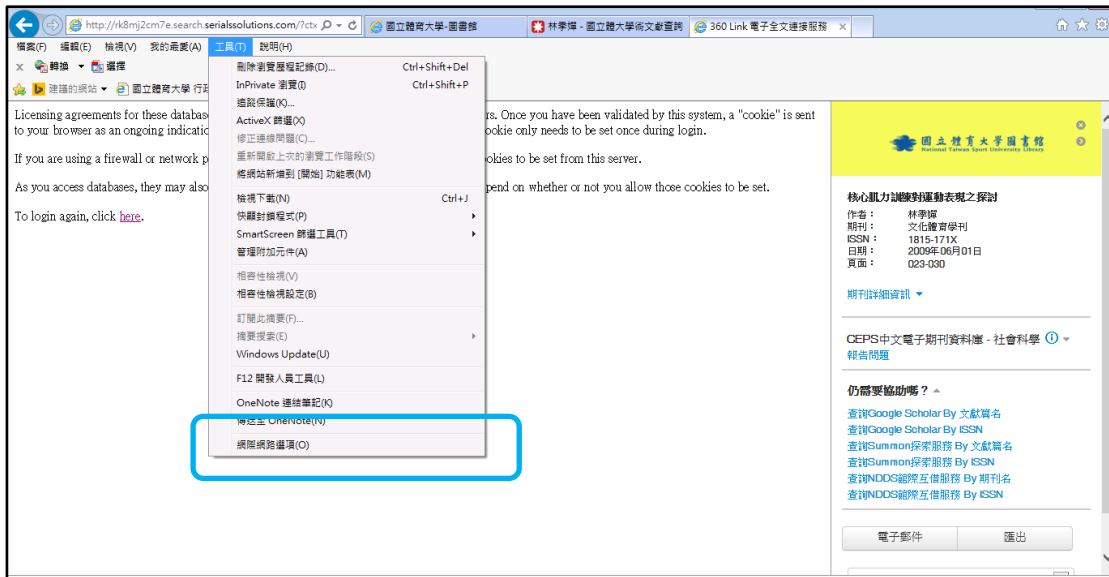

2. 選取隱私權頁籤→並點選網站按鈕

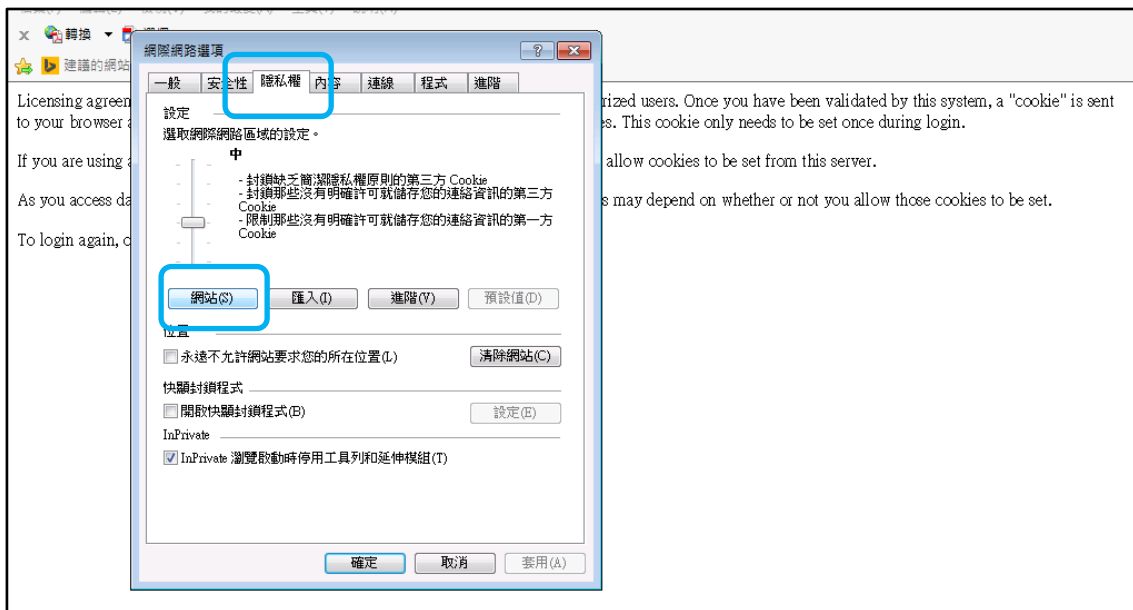



3. 輸入以下兩個網址，並點選允許，確定後關掉瀏覽器後再重新登入使用即可。

- <http://192.83.181.77:2048/cookie>
- <http://ezproxy.ntsui.edu.tw:2048/login>

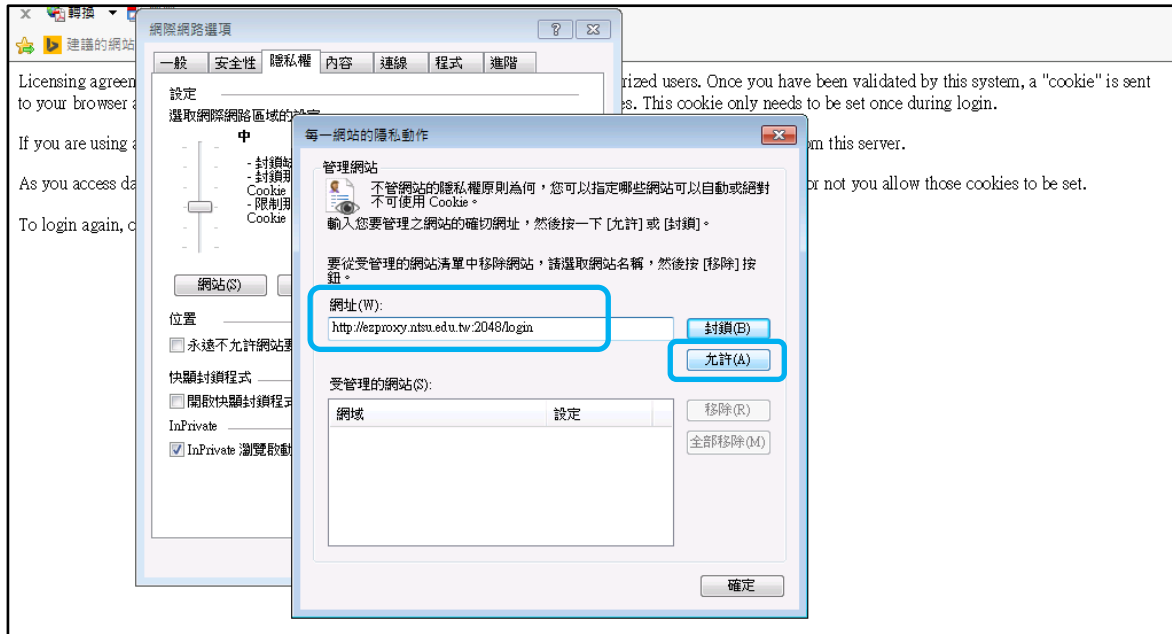

謝謝您的使用，說明完畢。